

Instructions

Maxim 3000â Turbo Hand Flush Installation

INTRODUCTION

Satellite portable restrooms and accessories must be assembled according to approved assembly procedures. Avoid variations in assembly procedures, which could adversely affect product life and warranty.

HARDWARE:

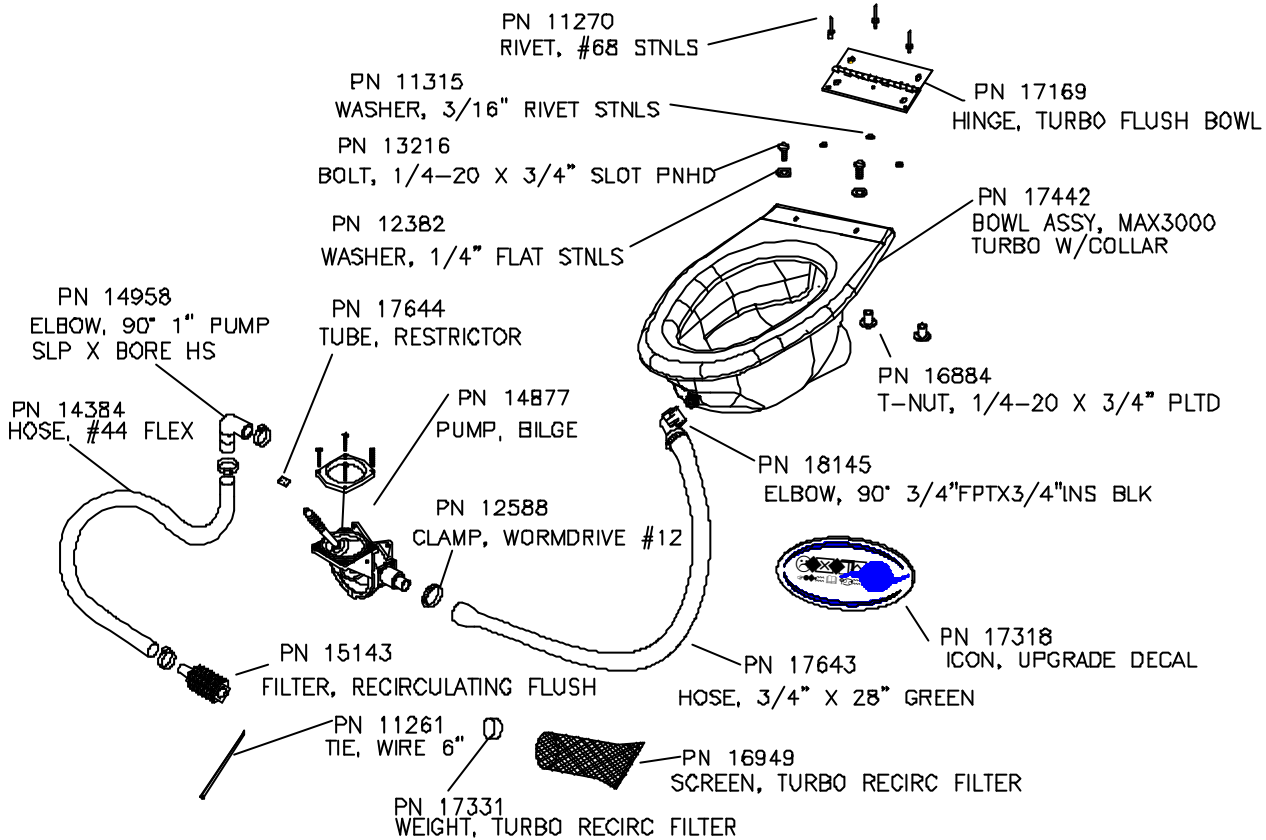

TOOLS:

- DRILL ELEC/CORDLESS
- #10 AND 5/16" DRILL BITS
- HOLE SAW 3-5/8"
- 5/16" NUT DRIVER
- STANDARD SCREWDRIVER
- RIVET GUN
- TAPE MEASURE
- MARKER

Drill holes for pump.

Locate dimple from right side 7.00" [177.80 mm] and from front tank indent area 3.00" [76.20 mm]. Drill with 3-5/8" [92.10mm] hole saw. Drill 2nd hole with 5/16" [8mm] drill bit.

Place pump bezel plate over 3-5/8" hole and align lower left corner with 5/16" hole (as shown). Bezel should be turned at 30 degrees to outside of tank. Drill remaining (3) holes with 5/16" [8mm] drill bit through bezel.

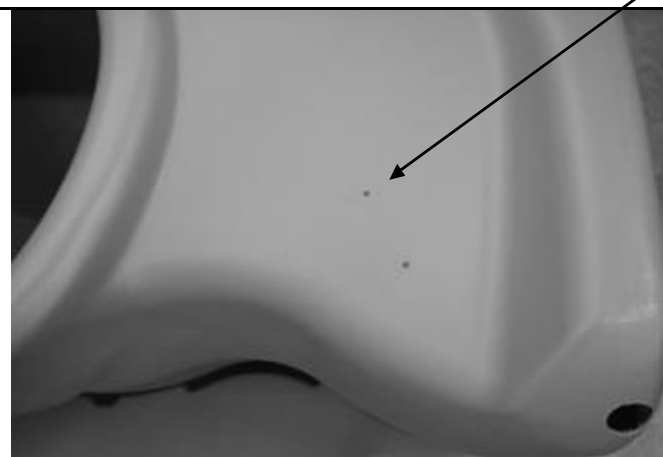

Pump mounting.

Pump mounts with elbow toward tank side and green hose towards bowl opening.



Insert handle through opening and secure with pump bezel and screws provided.



Start screws by hand and tighten with flat screwdriver or drill with flat standard screwdriver bit.



Install the hinge.

Position the hinge using the plastic screws supplied with the toilet seat. Drill (3) # 10 (3/16") [5mm] holes using the three holes in the hinge as a guide.



Prepare Tank and Install the Bowl assembly with Jig saw:

Remove the plastic screws. Rivet the hinge to the tank using (3) stainless rivets and backup washers



Place bowl in tank and mark a center line on the tank rim using the center of the nozzle in the bowl.



Cut out the pattern and place the instruction template over rim and align with center line and mark cut out.



Using a jigsaw, cut out marked out clearance notch



Or Prepare Tank with 2" hole saw:

Drill dimple on inside of tank rim with a 2" hole saw. Start drill straight into dimple, until pilot bit goes through inside surface.



Tilt hole saw at 90 degrees of toilet rim. Drill through surface. Clean and deburr hole.



Install the Bowl and Toilet Seat.

Attach the hose to the bowl. Use teflon tape on nozzle. Thread bowl with nozzle into 90-degree elbow.



Position the T-Nuts as shown on the hinge. Close the hinge.



Fasten the Bowl and Toilet Seat.

Position the Bowl and Toilet Seat over the T-Nuts as shown. Hand thread (2) ¼-20 screws and flat washers into the T-Nut Lift front of bowl slightly. Tighten the screws. Snap the screw covers into place



Assemble the 'Luxury Flush & Wash' icon.

Position the Icon Decal 2" [51 mm] from the right side of the door and 2" [51 mm] above the raised detail on the door. Do not write on the door



Satellite Industries Europe: 67 avenue de la Toison d'Or - 1060 Bruxelles - Belgium
tel : 0032 / 2-542 56 56 fax : 0032 / 2-542 56 57
moreinfo@satellite.be - www.satellite.be

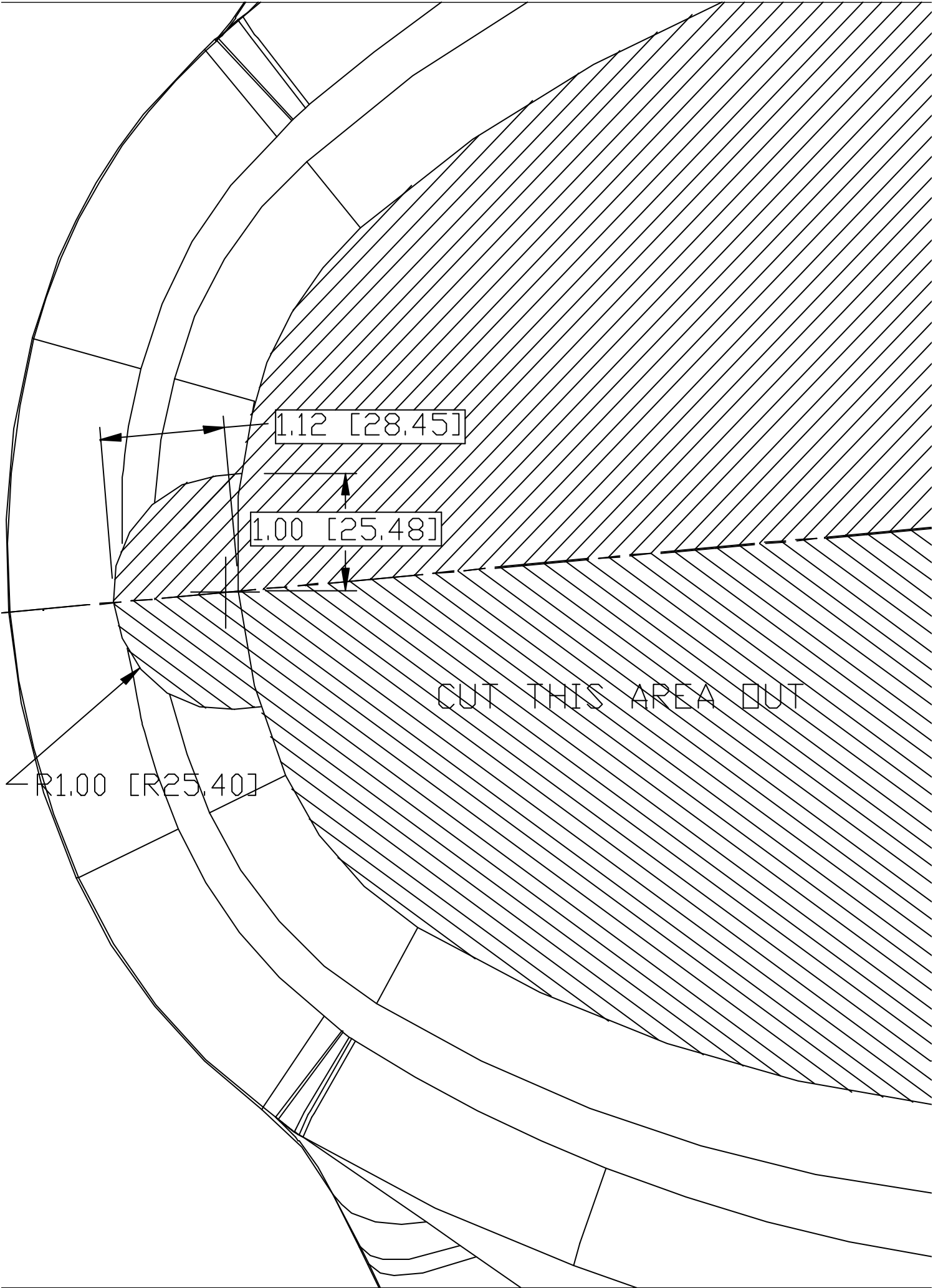

1.12 [28.45]

1.00 [25.48]

R1.00 [R25.40]

CUT THIS AREA OUT